

SG90 Micro Servo

Servo motor for Arduino and Raspberry-Pi robotics projects.
 Typical use: Model aircraft, cars and robots.
 Rotates forward or backwards to a given position.
 Bidirectional rotation - pulse duration determines the direction.

Item no: 87897 single pack, 90720 pack of 4 pcs.

Model no: SG90

Weight: 11g.

Rotation Angle: 180°

Torque: 1,8 kg/cm (11 Ncm) (at 4,8 V).

Torque: 2,4 kg/cm (15 Ncm) (at 6 V).

Speed: 0,12 sec/60° (at 4,8 V).

Speed: 0,10 sec/60° (at 6 V).

Linear response to PWM for easy ramping.

Operating voltage: 4,8-6 V.

Operating temperature: -10 to 50 °C.

Current max: < 600 mA.

Cable length: 250 mm.

Connector type: JR / Futaba / GWS

Breadboard friendly connector 2,54 mm pitch.

Connector wire gauge: 28 AWG.

Control system: PWM (Pulse Width Modulation)

Pulse Frequency / Duty cycle: 50 Hz / 20 ms square wave

Direction w/ Increasing PWM Signal: Counter Clockwise

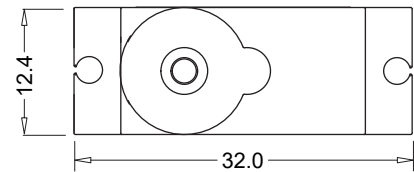
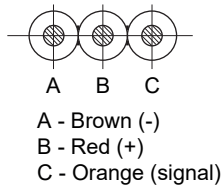
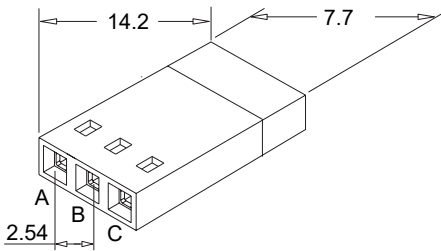
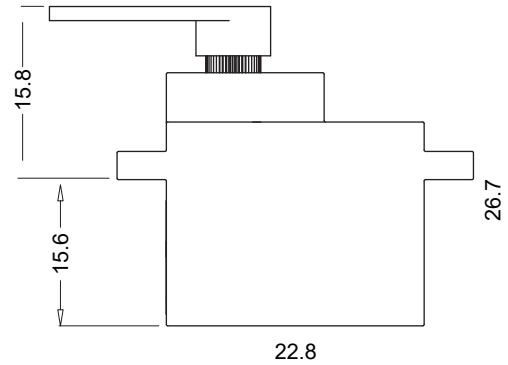
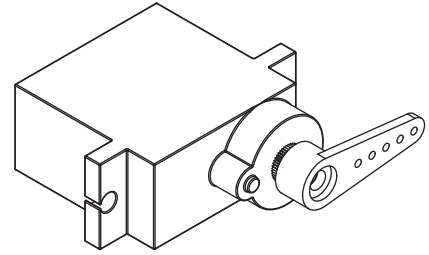

180° servo PWM signal timings

1 ms = 0° (minimum position)

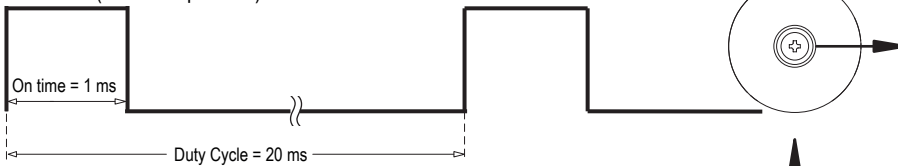

1,5 ms = 90° (center position)

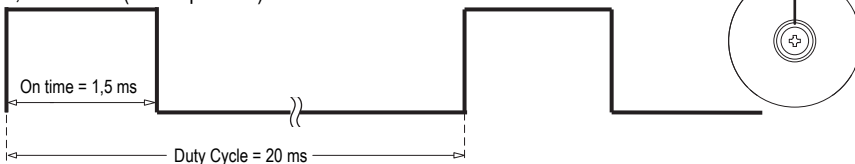

2 ms = 180° (maximum position)

